

# CUSTOM WALL MURALS

## INSTALLATION INSTRUCTIONS

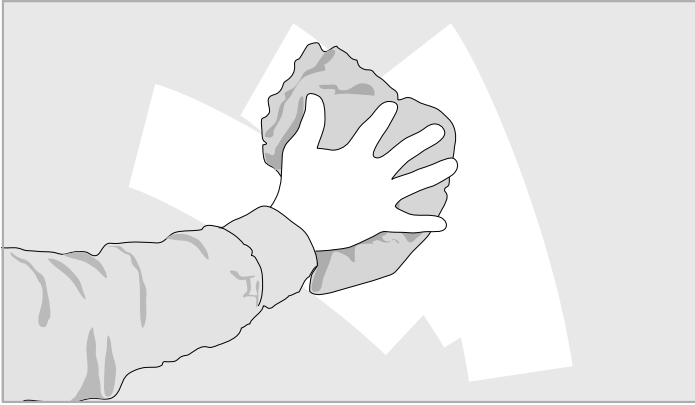

### Step 1: Surface prep

In order to make your mural stick you need to have a clean, dry surface. So with a dry cloth, give the wall a quick wipe down before you begin.



STEP LADDER

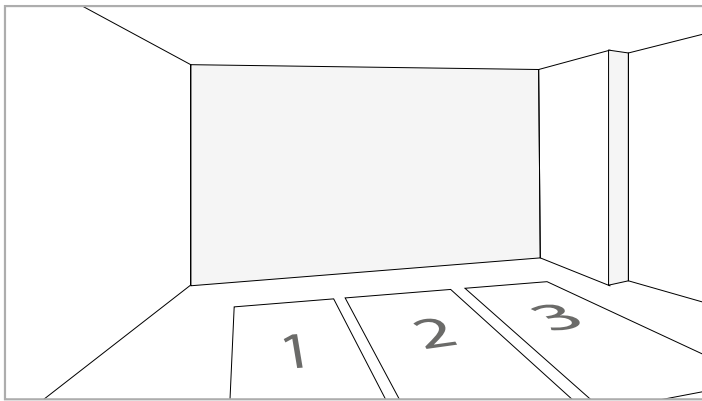

### Step 2: Panel prep

Unpack all parts of your vinyl and put it on a clean, solid surface for flattening. Position the panels in order from left to right, design side facing up.

You will need: Tape measure, spirit level, masking tape, pencil, step ladder, and scalpel/St Stanley knife or scissors.

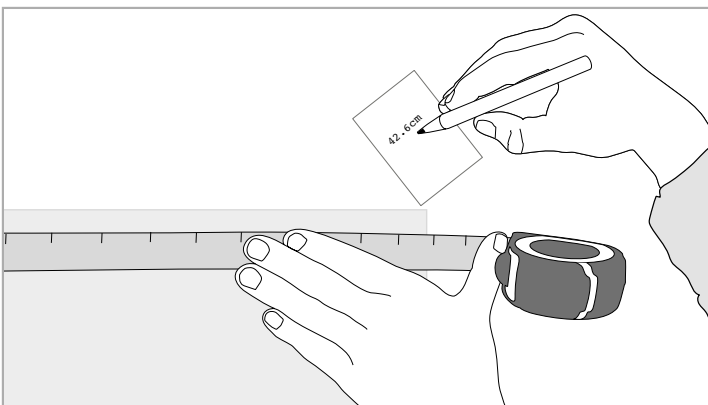

### Step 3: Measure (part 1)

Measure the width of the first panel, which is the one furthest to the left, and record the measurement on a piece of paper.



TAPE MEASURE



**Please note:** If you have recently painted your wall you will have to wait 4-6 weeks for the paint to fully cure.



STEP LADDER



2 PEOPLE



TAPE MEASURE



SPIRIT LEVEL



MASKING TAPE



SQUEEGEE



SCISSORS

# CUSTOM WALL MURALS

## INSTALLATION INSTRUCTIONS

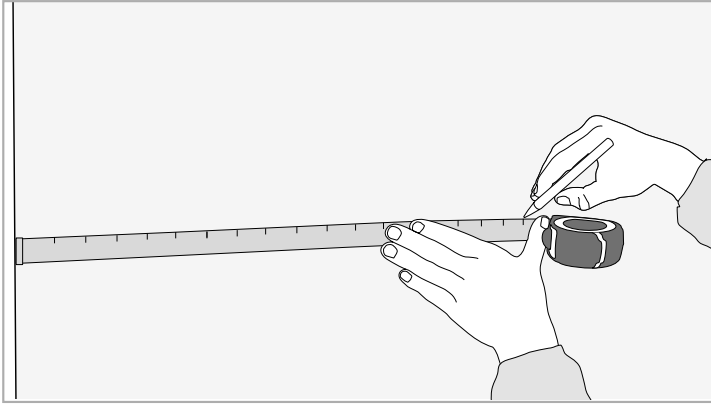

### Step 4: Measure (part 2)

Measure the same distance from the left corner of the wall and mark lightly with a pencil and inset your measurement by 2cm. This gives a little extra material in the corner of the wall to cover any uneven area on the application surface.



STEP LADDER



TAPE MEASURE

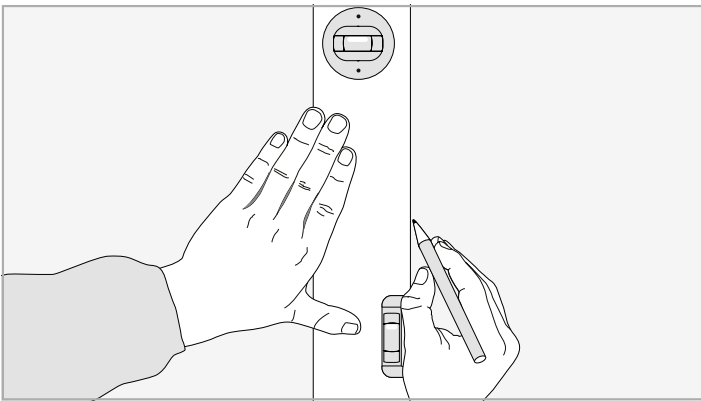

### Step 5: Align

Once you have created 2 or 3 more marks, join them using a spirit level to ensure they are straight. It is very important that they are straight as this line will effect the installation of the whole mural.



SPIRIT LEVEL



STEP LADDER

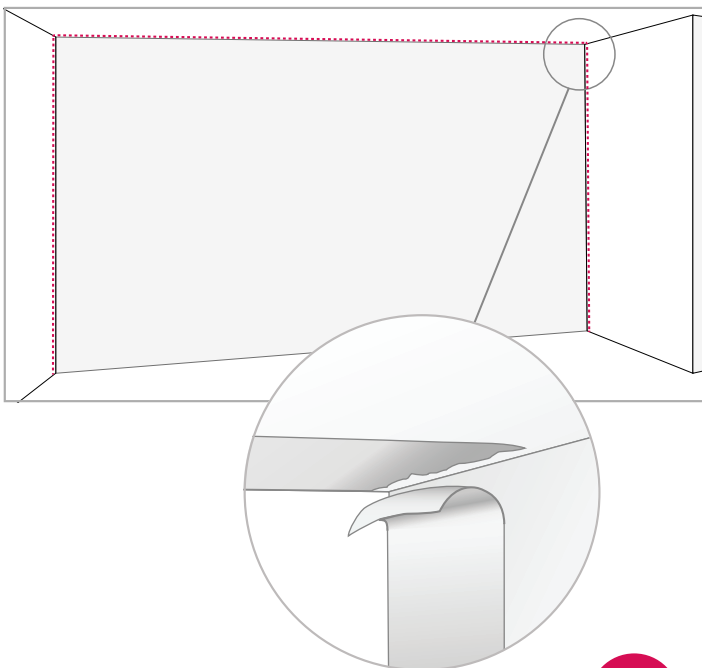

### Step 6: Preparing panel 1

Using masking tape, line the adjacent walls closest to the corners and along the ceiling, this is just a precaution to protect the paintwork from any adhesive.



MASKING TAPE



STEP LADDER



STEP LADDER



2 PEOPLE



TAPE MEASURE



SPIRIT LEVEL



MASKING TAPE



SQUEEGEE



SCISSORS

# CUSTOM WALL MURALS

## INSTALLATION INSTRUCTIONS

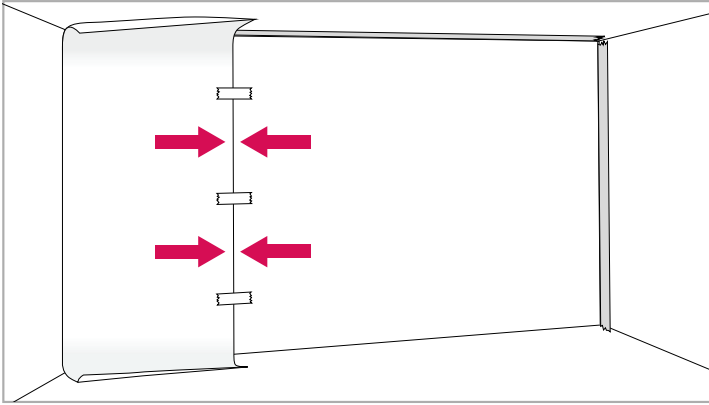

### Step 7: Preparing panel 2

Using small strips of masking tape to hold the panel in place, line the right hand edge of panel 1 up to the line you have drawn. The excess material will accommodate irregular walls, do not trim this yet.



STEP LADDER



2 PEOPLE



MASKING TAPE

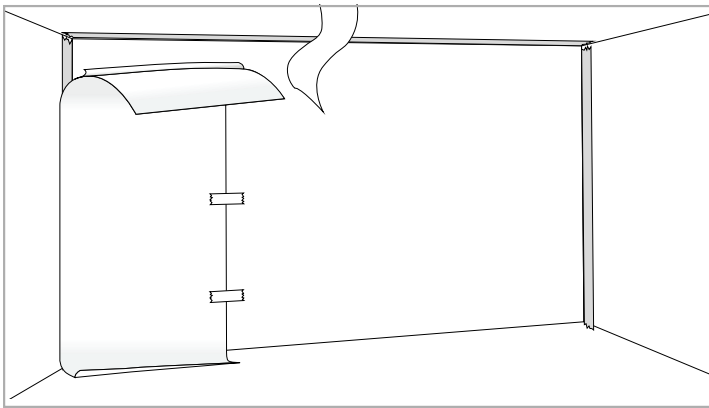

### Step 8: Preparing panel 1

Make sure there is enough masking tape all the way round your panel so it stays firmly in place. Peel back about 30cm of the backing paper and whilst keeping the decal under tension cut off the backing paper with scissors.



STEP LADDER



2 PEOPLE



SCISSORS



TAPE MEASURE

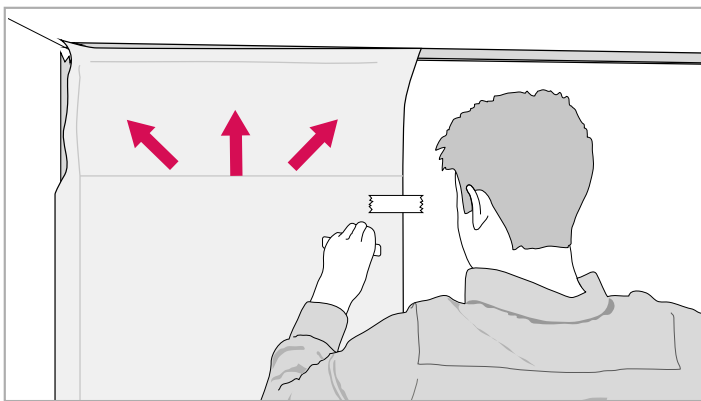

### Step 9: Sticking the panel (part 1)

Lower the decal to the wall and using the squeegee or plastic object start pressing the graphic onto the wall working from the bottom to the top, keeping tension on the far corners. Working the bottom to the top and at all time pushing from the centre out, smooth the sticky section into place.



SPIRIT LEVEL



2 PEOPLE



SQUEEGEE



**TAKE your time.** It's important Panel 1 is positioned correctly as this sets the bases for your wall.



STEP LADDER



2 PEOPLE



TAPE MEASURE



SPIRIT LEVEL



MASKING TAPE



SQUEEGEE



SCISSORS

# CUSTOM WALL MURALS

## INSTALLATION INSTRUCTIONS

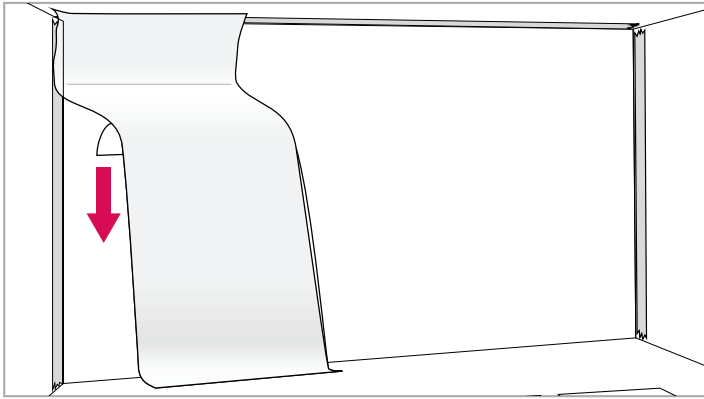

### Step 10: Sticking the panel (part 2)

Now remove the masking tape you have been using to hold the panel in place. Lift up the remaining panel and peel off the backing paper from the top to the bottom. It is helpful to have someone else to hold the bottom of the panel away from the wall until the whole panel is smoothed over.



2 PEOPLE



STEP LADDER

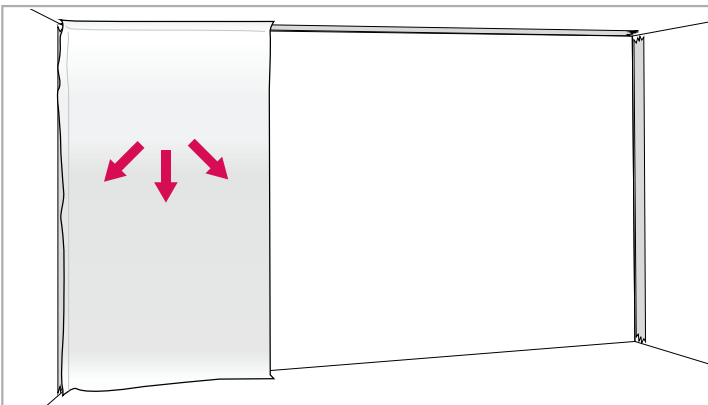

### Step 11: The smooth

Lower the decal to the wall keeping the bottom slightly away from the wall. Using the squeegee or plastic object start pressing the graphic onto the wall working from the top to the bottom smoothing the wrinkles and bubbles outwards, towards the edges.



SQUEEGEE



STEP LADDER

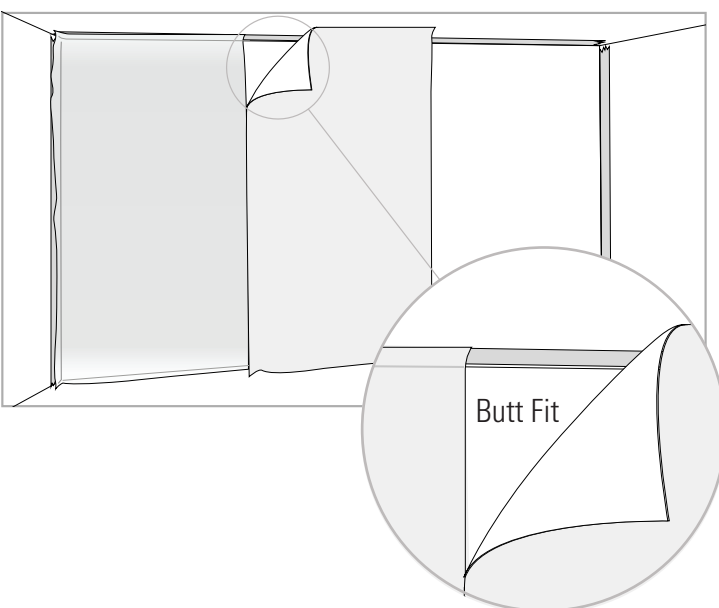

### Step 12: Panel 2

Panel 2 will butt fit (vinyl will meet precisely without overlapping or allowing space between) panel 1. It may be that you can visually align the panels by matching the design. This works best with one person matching the top and one the bottom.



2 PEOPLE



TAPE MEASURE



SPIRIT LEVEL



STEP LADDER



2 PEOPLE



TAPE MEASURE



SPIRIT LEVEL



MASKING TAPE



SQUEEGEE



SCISSORS

# CUSTOM WALL MURALS

## INSTALLATION INSTRUCTIONS

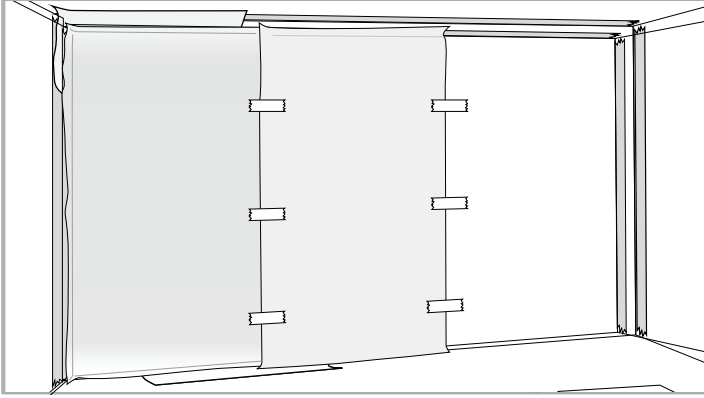

### Step 13: Preparing panel 1

Fix Panel 2 in the correct position using small strips of masking tape. At this point you can repeat steps 8 to 11.



MASKING TAPE

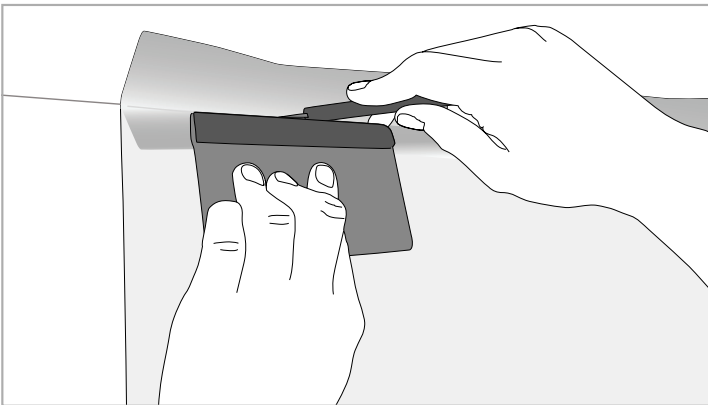

### Step 14: Trim

Once you have all panels applied trim all excess vinyl using a squeegee or plastic object. This is best achieved by pushing the squeegee firmly into the adjoining surfaces and then running a scalpel along the edge creating a clean cut line.



STEP LADDER



SQUEEGEE

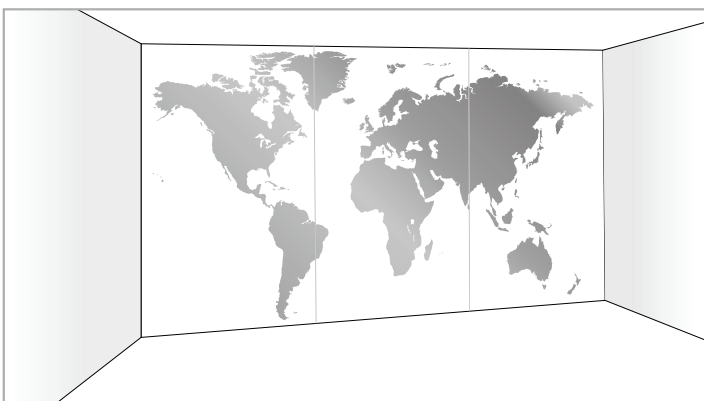

### Step 15: The big reveal

Small bubbling may occur after the graphic is on the wall but all you need to do is pop them with a push pin and smooth the area with a finger.



STEP LADDER



2 PEOPLE



TAPE MEASURE



SPIRIT LEVEL



MASKING TAPE



SQUEEGEE



SCISSORS